

SUPPLEMENT WDH 751-1001 SBB

Fitting the thermal insulation

1. General information

1.1 Relevant appliances

Thermal insulation

- WDH 751 SBB, part number 231923
- WDH 1001 SBB, part number 231924

As an accessory for the floorstanding DHW cylinders

SBB 751 | SBB 1001 | SBB 751 SOL | SBB 1001 SOL



Note

Observe the operating and installation instructions provided with the appliance.

1.2 Further applicable documents

Operating and installation instructions, floorstanding DHW cylinder SBB 751 | SBB 1001 | SBB 751 SOL | SBB 1001 SOL

2. Fitting the thermal insulation

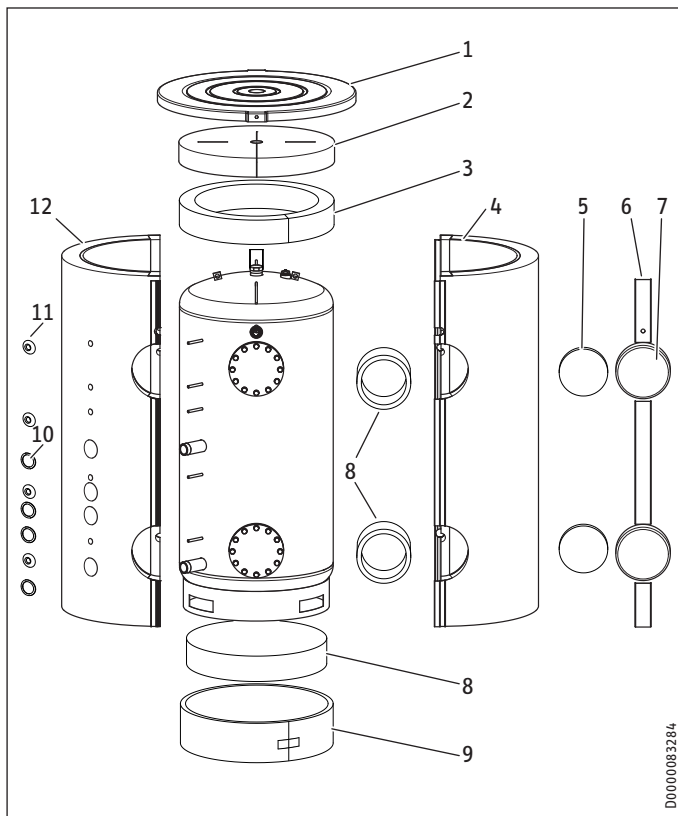

- Cover 2
- Top thermal insulation section 3
- Top thermal insulation ring 4
- R.h. thermal insulation section 5
- Thermal insulation, flange 6
- Cover strip 7
- Flange cover 8
- Flange thermal insulation ring 9
- Thermal insulation section, bottom 10
- Thermal insulation ring, bottom 11
- Connection cover (including insulation)

- Rose 13
 - Left thermal insulation section
- ▶ On cylinders supplied horizontally, insert the bottom thermal insulation section inside the support ring, prior to positioning the cylinder. Slightly tip the vertically delivered cylinder in order to position the bottom thermal insulation section.
 - ▶ Surround the support ring with the bottom thermal insulation ring and secure it with adhesive tape.
 - ▶ Prior to fitting them, shape the right hand and left hand thermal insulation sections into a semi-circular form for approx. 10 seconds. A pressure-activated adhesive then holds the thermal insulation sections in the required shape and makes fitting them easier.
Please note that the use of tensioning straps may damage the thermal insulation.
 - ▶ Push the thermal insulation sections over the connections on the appliance.
 - ▶ Connect the thermal insulation sections at the front by clipping the hook closure strip into the last hook strip. If necessary, the short black cover strips can be used to temporarily hold the hook closure strips together.
 - ▶ Position the thermal insulation sections around the cylinder and connect the thermal insulation sections at the back by clipping the hook closure strip into the first or second hook strip.
 - ▶ Adjust the thermal insulation sections on the appliance by patting and pressing them down with the palm of the hand.
 - ▶ Starting from the top, reighten the hook closure strip from the top until it hooks into the final hook strip.
 - ▶ Place one thermal insulation ring around each flange to completely fill the gaps to the side insulation segments.
 - ▶ Place the upper thermal insulation ring and thermal insulation section on top. Use the slit to route the consumption indicator over the thermal insulation to the front of the appliance.

SUPPLEMENT WDH 751-1001 SBB

Fitting the thermal insulation

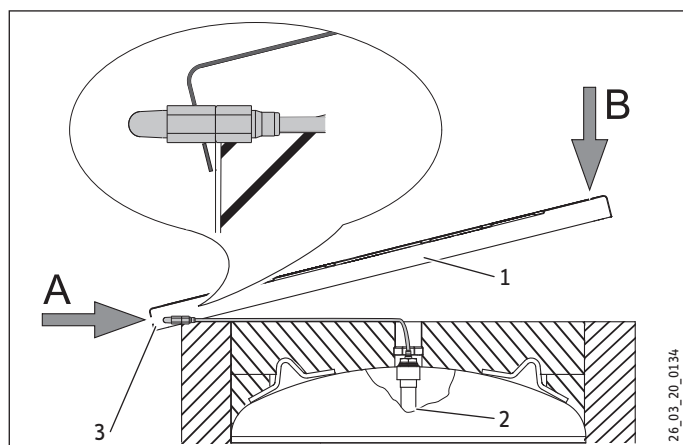

- 1 Cover
- 2 Protective anode
- 3 Signal anode consumption indicator

- ▶ Position the cover on the appliance, starting at the front, and guide the consumption indicator of the anode through the recess in the edge of the cover.
- ▶ Place the cover over the thermal insulation sections.
- ▶ Affix the label "Signal anode information" in a clearly visible position on the thermal insulation.
- ▶ Fit the cover strips onto the hook closure strips. If required, the cover strips can be trimmed to size.
- ▶ Fill the hollow spaces near the connections with the soft foam inserts.
- ▶ Push the roses and caps into the apertures.



Note

Affix the additional type plate in a clearly visible position on the thermal insulation.